

WL-200/200A

WingLoc

Quick Release Wing Nut

The WingLoc's quick release design makes attaching and removing cymbals quick and easy.

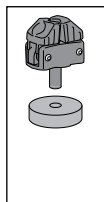

WL-200

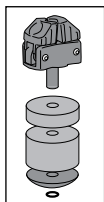

WL-200A

WingLoc Attachment

To attach, open the wings and place the WingLoc and the Upper Felt Washer over the Cymbal Post as shown in (Fig. 2).

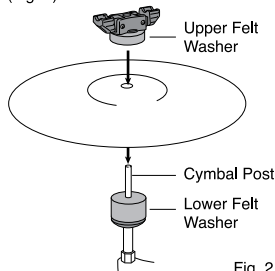

Fig. 2

WingLoc Locked

Snap the other wing upward as shown in (Fig. 4) to lock the WingLoc in place.

Note: To prevent wear to the threads, do not tighten the WingLoc when both wings are in the locked position.

Note: Keep WingLocs in the locked position when transporting to avoid breakage or loss.

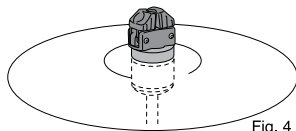

Fig. 4

WingLoc Removal

To remove the WingLoc, pull the wings apart ① and lift the WingLoc straight up ② as shown in (Fig. 1).

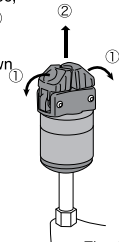

Fig. 1

WingLoc Adjustment

Snap either one of the wings upward as shown in (Fig. 3) and rotate the WingLoc until the desired tightness/looseness of the cymbal is achieved.

Note: Do not force the wings closed. If you feel resistance, rotate the WingLoc slightly to align the threads and try closing the wings again.

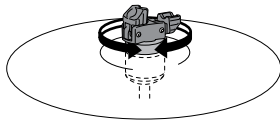
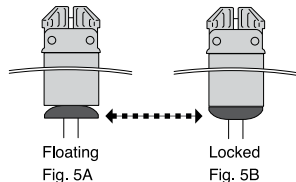

Fig. 3

Reversible Seat Cup

The Seat Cup is reversible and can be set to Float, to allow cymbals to move freely, when set in the position shown in (Fig. 5A) or it can Lock, to prevent rattle in recording situations, when set in the position shown in (Fig. 5B).



Floating
Fig. 5A

Locked
Fig. 5B